

HIKER ENTERPRISES LTD

FOOT PRESS SYSTEM

EXPLODED VIEW

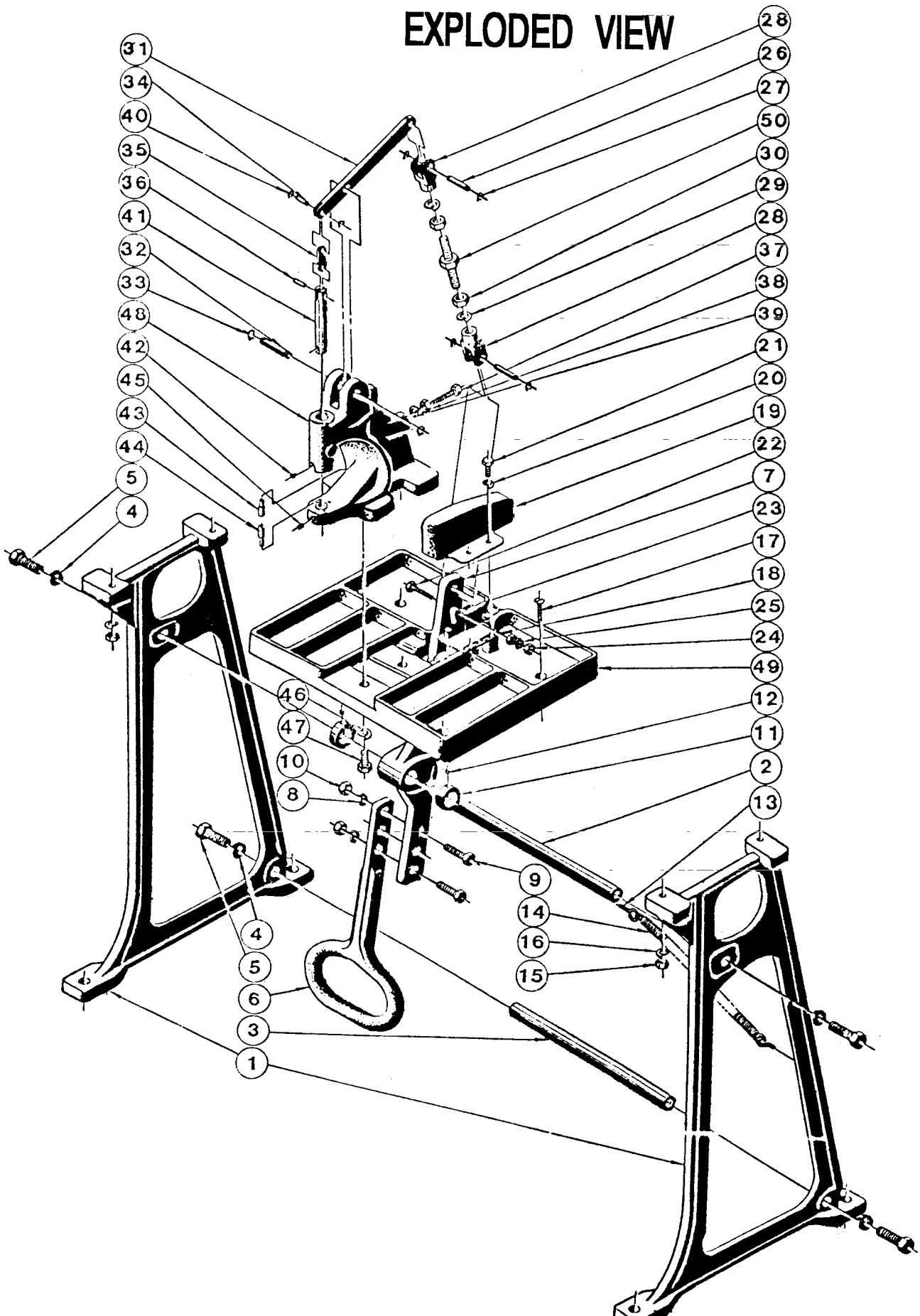

零 件 表
PARTS LIST

組別 項次 Group Item	名 稱 Description	數量 Qty	附 記 Remarks
01	底架SIDE SUPPORTING PLATE	2	(左、右)
02	支撐軸(上) UPPER SUPPORT ROD	1	1"×401 ℓ
03	支撐軸(下) LOWER SUPPORT ROD	1	1"×406 ℓ
04	彈簧墊圈SPRING WASHER	4	5/8"
05	固定螺絲FIXING SCREW	4	5/8"×1 3/4" ℓ
06	腳踏PEDAL	1	
07	傳力槓桿Link-PLATE	1	
08	彈簧墊圈SPRING WASHER	2	1/2"
09	固定螺絲FIXING SCREW	2	1/2"×1 1/2" ℓ
10	螺帽NUT	2	1/2"
11	固定環套RING LOCK WITH SCREW	2	1"×1 1/2"×16'
12	固定螺絲FIXING SCREW	2	5/16"×1/4" ℓ 無頭
13	彈簧勾環HOOK	2	
14	彈簧SPRING	1	
15	螺帽NUT	4	5/16"
16	彈簧墊圈SPRING WASHER	4	5/16"
17	固定螺絲FIXING SCREW	4	5/16"×1 1/2" ℓ
18	單向齒座FULL WAY GEAR PLATE	1	
19	齒座護蓋GEAR COVER	1	
20	彈簧墊圈SPRING WASHER	2	5/16"
21	固定螺絲FIXING SCREW	2	5/16"×1" ℓ
22	螺絲SCREW	1	5/16"×1 3/4" ℓ
23	擺動控制鐵SWING KEY	1	
24	螺帽NUT	2	5/16"
25	彈簧墊圈SPRING WASHER	1	5/16"
26	連接梢YOKE PIN	2	3/8"×46 ℓ
27	C形扣環(外扣) SPRING LOCK PING	4	3/8"
28	U形接頭(左、右牙) U-YOKE	2	
29	彈簧墊圈SPRING WASHER	2	1/2"
30	螺帽NUT	2	1/2"
31	壓板PRESSING ARM	1	
32	壓板支點梢PRESS PIN	1	7/16"×60 ℓ
33	C形扣環(外扣) SPRING LOCK RING	2	7/16"
34	連接梢PIN	1	5/16"×24 ℓ
35	傳力片LINK PLATE	1	
36	連接梢LINK PIN	1	5/16"×17 ℓ
37	調整螺絲ADJUSTING SCREW	1	3/8"×2" ℓ
38	固定螺帽FIXING NUT	1	3/8"
39	彈簧墊圈SPRING WASHER	1	3/8"
40	C形扣環(外扣) SPRING LOCK RING	2	5/16"
41	傳力心軸ARBOR	1	
42	上模固定螺絲SCREW, UPPER DIE	1	1/4"×1/4" ℓ
43	上模組UPPER DIE	1	
44	下模組LOWER DIE	1	
45	下模固定螺絲SCREW, LOWER DIE	1	1/4"×1/4" ℓ
46	彈簧墊圈SPRING WASHER	2	1/2"
47	固定螺絲FIXING SCREW	2	1/2"×1" ℓ
48	機身BODY	1	
49	工作平板WORKING PLATE	1	
50	接連螺桿THREAD BOLT	1	